

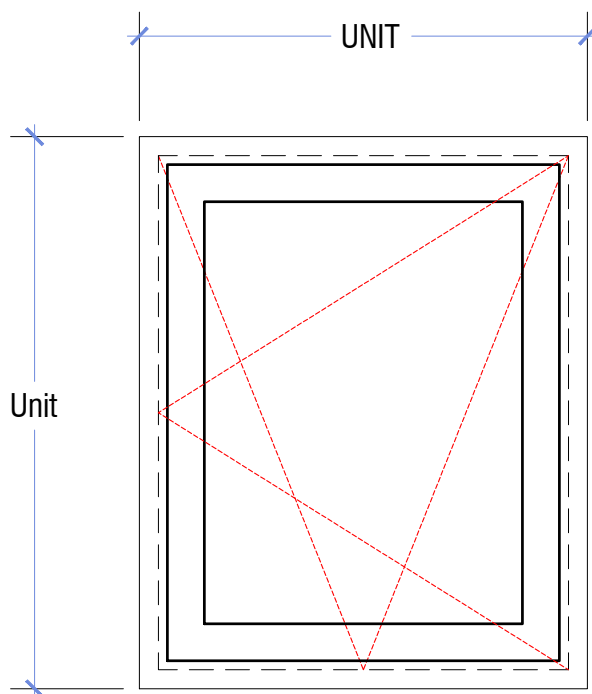

7463 Research Dr  
Almont MI 48003  
810-798-2817 ph  
810-798-3814 fx

Custom Design • Restoration • Reproduction



Copyright 2016, Grabill Window & Doors, Inc.

1" = 1'-0"

### 1.75" INSWING CASEMENT ELEVATION

Sales Binder

[www.grabillwindow.com](http://www.grabillwindow.com)

*Grabill Architectural Drawings contain confidential and proprietary information and is for the sole use of the intended recipient(s).*

*Any unauthorized review, use, disclosure or distribution of these drawing (including attachments) is strictly prohibited.*



7463 Research Dr  
Almont MI 48003  
810-798-2817 ph  
810-798-3814 fx

Custom Design • Restoration • Reproduction

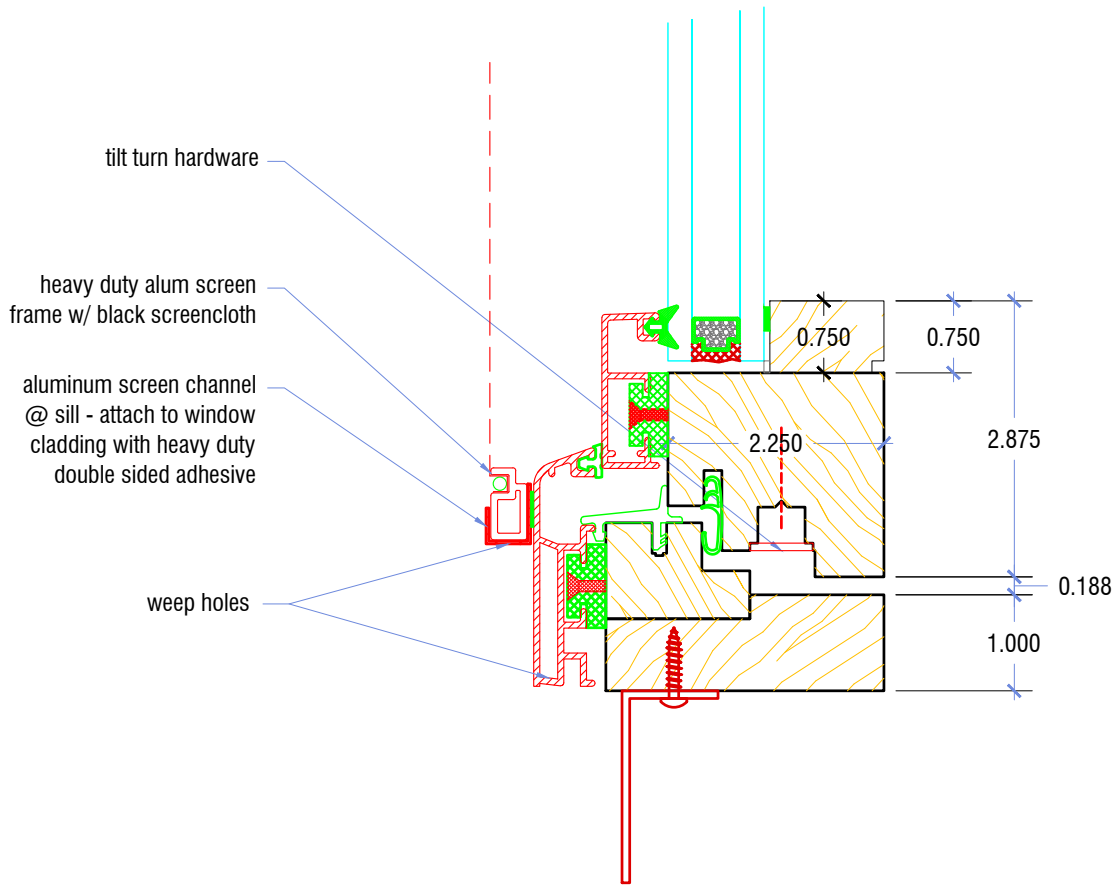

Copyright 2016, Grabill Window & Doors, Inc.

6" = 1'-0"

1.75" ALUMINUM CLAD INSWING CASEMENT W/ SCREEN AT SILL

*Grabill Architectural Drawings contain confidential and proprietary information and is for the sole use of the intended recipient(s).*

*Any unauthorized review, use, disclosure or distribution of these drawing (including attachments) is strictly prohibited.*

Sales Binder

www.grabillwindow.com



7463 Research Dr  
Almont MI 48003  
810-798-2817 ph  
810-798-3814 fx

Custom Design • Restoration • Reproduction

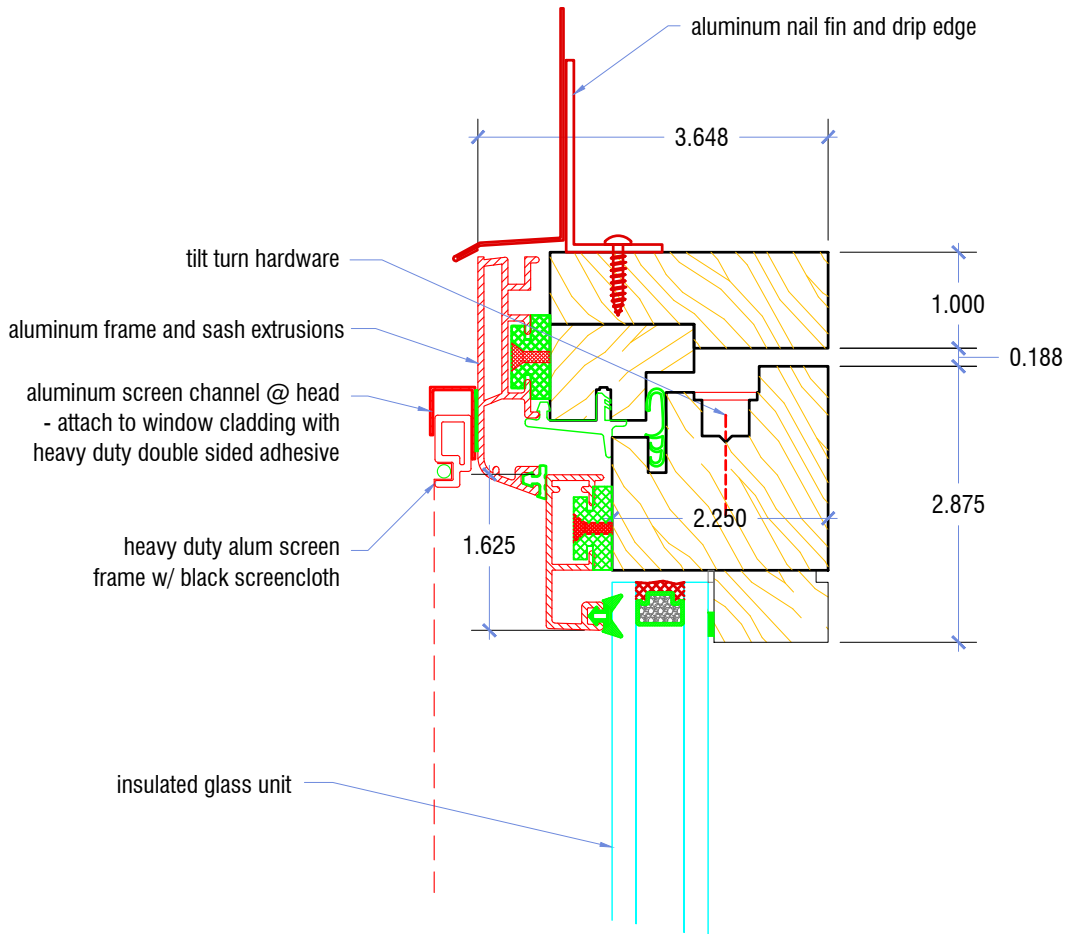

Copyright 2016, Grabill Window & Doors, Inc.

6" = 1'-0"

1.75" ALUMINUM CLAD INSWING CASEMENT W/ SCREEN AT HEAD

Grabill Architectural Drawings contain confidential and proprietary information and is for the sole use of the intended recipient(s).

Any unauthorized review, use, disclosure or distribution of these drawing (including attachments) is strictly prohibited.

Sales Binder

www.grabillwindow.com



7463 Research Dr  
 Almont MI 48003  
 810-798-2817 ph  
 810-798-3814 fx

Custom Design • Restoration • Reproduction

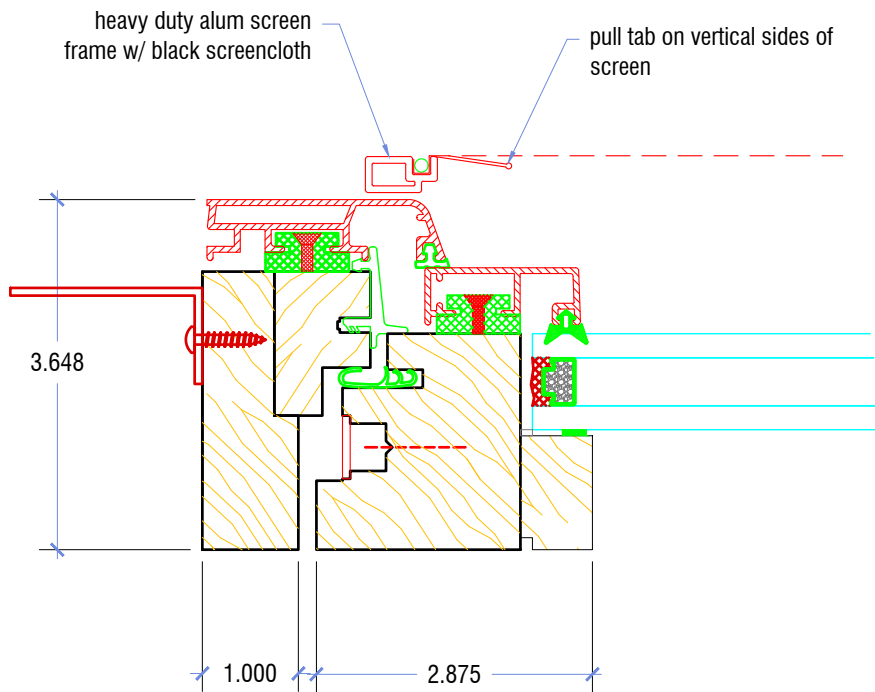

Copyright 2016, Grabill Window & Doors, Inc.

$$6'' = 1'-0''$$

1.75" ALUMINUM GLAD INSWING CASEMENT W/ SCREEN AT 6"

*Grabill Architectural Drawings contain confidential and proprietary information and is for the sole use of the intended recipient(s).*

*Any unauthorized review, use, disclosure or distribution of these drawing (including attachments) is strictly prohibited.*

Sales Binder

www.grabillwindow.com